

EXTERIOR PAINTING AT RIVERBANK HIGH SCHOOL

6200 CLAUS ROAD, RIVERBANK, CA 95367

RIVERBANK UNIFIED SCHOOL DISTRICT



ABV	ABOVE	LTWT	LIGHT WEIGHT
AFF	ABOVE FINISH FLOOR	L	LONGLENGTH
ACC	ACCESSIBLE	LV	LOUVER VENT
ACCU	ADJUSTABLE	MB	MACHINE BOLT
ADJ	ADJUSTABLE	MH	MANHOLE
AC	AIR CONDITIONING	MANUFACTURER	MANUFACTURER
ALT	ALTERNATE	MAS	MASONRY
ALUM	ALUMINUM	MAX	MAXIMUM
AB	ANCHOR BOLT	MECH	MECHANICAL
ANOD	ANODIZED	METAL	METAL
ARCH	ARCHITECT(URAL)	MIN	MINIMUM
AC	ASPHALT CONCRETE	MISC	MISCELLANEOUS
APL	ASSUMED PROPERTY LINE	MTD	MOUNTED
AUTO	AUTOMATIC	(N)	NEW
BM	BEAM	NRC	NOISE REDUCTION COEFF.
BET	BETWEEN	NOM	NOMINAL
BLK	BLOCK	N	NORTH
BLKG	BLOCKING	NIC	NOT IN CONTRACT
BD	BOARD	NTS	NOT TO SCALE
BOT	BOTTOM	NO#	NUMBER
BOB	BOTTOM OF BEAM	OC	ON CENTER
BLDG	BUILDING	OPNG	OPENING
CIP	CAST IN PLACE	OD	OUTSIDE DIAMETER
CB	CATCH BASIN	O'	OVER
CLKG	CAULKING	OFOI	OWNER FURNISHED OWNER INSTALLED
CLG	CEILING	OWNER FURNISHED	OWNER FURNISHED
CJ	CEILING JOIST / CONTROL JOINT	CONTRACTOR INSTALLED	CONTRACTOR INSTALLED
CEM	CEMENT	PAIR	PAIR
CL	CHAIN LINK	PTD	PAPER TOWEL DISPENSER
CO	CLEAN OUT	d	PENNY
CLR	CLEAR(ANCE)	PERF	PERFORATED
COL	COLUMN	PLASTER	PLASTER
COMB	COMBINATION	PLYWOOD	PLYWOOD
CONC	CONCRETE	PT	POINT
CMU	CONCRETE MASONRY UNIT	POC	POINT OF CONNECTION
CONST	CONSTRUCTION	PVC	POLYVINYL CHLORIDE
CONT	CONTINUOUS	PSI	POUNDS PER SQ. INCH
CTSK	COUNTER SINK	PSF	POUNDS PER SQ.FT.
CP	DEEP	PREFAB	PREFABRICATED
D	DEEP (DEPTH)	P.T.	PRESSURE TREATED
DEPT	DEPARTMENT	PTDF	PRESSURE TREATED DOUG. FIR
DTL	DETAIL	PROJ	PROJECT
DIAG	DIAGONAL	P.L.	PROPERTY LINE
DIA	DIAMETER	RAD	RADIUS
DIM	DIMENSION	REF	REFERENCE
DISP	DISPENSER	REFL	REFLECTED
DR	DOOR	REFR	REFRIDGERATOR
DBL	DOUBLE	REINF	REINFORCE(ING)
DF	DOUGLAS FIR	REQ	REQUIRED
DN	DOWN	RA	RETURN AIR
DS	DOWN SPOUT	REV	REVISION(S)/REVISED
DWG	DRAWING	ROW	RIGHT OF WAY
DF	DRINKING FOUNTAIN	R	RISER/RADIUS
EA	EACH	RD	ROOF DRAIN
EW	EACH WAY	RM	ROOM
E	EAST	RO	ROUGH OPENING
EWC	ELECT. WATER COOLER	RB	RUBBER BASE
ELEC	ELECTRIC(AL)	SECT	SECTION
ELEV	ELEVATION	SHTG	SHEATHING
EMER	EMERGENCY	SHT	SHEET
ENCL	ENCLOSURE	SM	SHEET METAL
EQ	EQUAL	SIM	SIMILAR
EXH	EXHAUST	SD	SOAP DISPENSER
EJ	EXISTING	SC	SOLID CORE
EXP	EXPANSION JOINT	STC	SOUND TRANSMISSION COEFF.
EXT	EXPOSED/EXPANSION	S	SOUTH
FOC	FACE OF CONCRETE	SPEC	SPECIFICATION
FOF	FACE OF FINISH	SQ	SQUARE
FOS	FACE OF STUD/STRUCTURE	SF	SQUARE FOOT
FIN	FINISH	SS	STAINLESS STEEL
FF	FINISH FLOOR	STD	STANDARD
FA	FIRE ALARM	STL	STEEL
FE	FIRE EXTINGUISHER	STOR	STORAGE
FEC	FIRE EXTINGUISHER CABINET	STRUCT	STRUCTURE
FH	FIRE HYDRANT	S4S	SURFACE FOUR SIDES
FLASH	FLASHING	SUSP	SUSPENDED
FLR	FLOOR	SAT	SUSPENDED ACOUSTICAL TILE
FT	FOOT / FEET	SYM	SYMMETRICAL
FTG	FOOTING	TB	TACKBOARD
FDN	FOUNDATION	TEL	TELEPHONE
GA	GAGE / GAUGE	TV	TELEVISION
GI	GALVANIZED IRON	THK	THICK
GL	GLASS / GLAZING	THRES	THRESHOLD
GALV	GLAVANIZED	T&G	TONGUE & GROOVE
GLB	GLUE LAMINATED BEAM	TOB	TOP OF BEAM
GB	GRAB BAR	TOC	TOP OF CURB/CONCRETE
GND	GROUND	TOP	TOP OF PLATE/PAVEMENT
GYP	GYP SUM	TOS	TOP OF SHEATHING STEEL/SLAB
GYPBD	GYP SUM BOARD	TOW	TOP OF WALKWALL
HDW	HARDWARE	T	TREAD
HDR	HEADER	TYP	TYPICAL
HVAC	HEATING/VENTILATING/IR CONDITION	UNO	UNLESS NOTED OTHERWISE
HT	HEIGHT	UR	URINAL
H	HIGH	VERT	VERTICAL
HC	HOLLOW CORE	VCT	VINYL COMPOSITION TILE
HM	HOLLOW METAL	WSCOT	WAINSCOT
HSS	HOLLOW STRUCTURAL SECTION	WC	WATER CLOSET
HORIZ	HORIZONTAL	WH	WATER HEATER
HB	HOSE BIB	WP	WATER PROOFING
HR	HOUR	WR	WATER RESISTANCE
IN	INCH	WT	WEIGHT
ID	INSIDE DIAMETER	WWF	WELDED WIRE FABRIC
INSUL	INSULATION	W	WEST/WIDTHWIDE
INT	INTERIOR	WDW	WINDOW
LAB	LABORATORY	W	WITH
LAM	LAMINATE(D)	W/O	WITHOUT
LAV	LAVATORY	WD	WOOD
LT	LIGHT	WWM	WOVEN WIRE MESH
		WI	WROUGHT IRON

GENERAL NOTES	
01.	PAIN ALL EXTERIOR SURFACES, INCLUDING BUT NOT LIMITED TO: WALL SURFACES, DOORS, METAL WINDOWS, WINDOW GLAZING COMPOUNDS, EXPOSED CONDUIT AND PIPING, TRIM, GUTTERS, DOWNSPOUTS, HANDRAILS, GUARDRAILS (EXCEPT WHERE UNFINISHED GALVANIZED), PLASTER SOFFITS, BUILDING OVERHANGS, AND EXPOSED CONCRETE FOUNDATIONS - NO PAINTING OF MECHANICAL UNITS OR CONDUIT ON THE ROOF U.O.
02.	EXTERIOR AND INTERIOR DOORS AND FRAMES / TRIM TO BE PAINTED ON INTERIOR AND EXTERIOR FACES. REPAINT ANY ADJACENT SURFACES DAMAGED BY CONSTRUCTION ACTIVITIES
03.	CONTRACTOR TO ALLOW FOR UP TO A FIVE (5) COLOR PAINT SCHEME
04.	NO WORK ON METAL LOCKERS - PROTECT LOCKERS FROM OVERSPRAY - TYPICAL
05.	EXTERIOR UNPAINTED GALVANIZED OR POWDER COATED HANDRAILS, GUARDRAILS, AND FENCES TO REMAIN - DO NOT PAINT UNLESS NOTED OTHERWISE
06.	FIRE ALARM DEVICES ARE NOT TO BE PAINTED
07.	THE DISTRICT SHALL REMOVE ALL POSTERS, ART, ETC. FROM INTERIOR DOOR SURFACES TO BE PAINTED PRIOR TO INTERIOR PAINTING
08.	THE CONTRACTOR SHALL REMOVE DOOR NUMBER AND WALL SIGNAGE FROM DOORS, FRAMES, AND WALLS. PERMANENT SIGNAGE TO BE REINSTALLED BY THE CONTRACTOR. NEW VINYL DOOR IDENTIFICATION SYMBOLS SHALL BE FURNISHED AND INSTALLED BY THE CONTRACTOR - VERIFY FONT TYPE, SIZE, AND COLOR WITH OWNER. CONTRACTOR SHALL REMOVE AND REINSTALL HANDICAP ACCESSIBILITY SIGNAGE TO ACCOMMODATE PAINTING WORK
09.	WHERE T1-11 WOOD SIDING OCCURS CONTRACTOR SHALL BRUSH APPLY ONE ADDITIONAL COAT OF PAINT INTO GROOVES OF THE T1-11 WOOD SIDING PRIOR TO PAINTING THE WALLS. WITH EACH SUCCEEDING COAT GROOVES ARE TO BE BACK BRUSHED AFTER PAINT APPLICATION TO ENSURE THOROUGH COVERAGE
10.	CAULK AND SEAL DAMAGED JOINTS AND CRACKS IN EXISTING EXTERIOR MATERIALS PRIOR TO FINAL COAT OF PAINT. SEE PROJECT MANUAL SECTION 07920
11.	CONTRACTOR SHALL NOTIFY ARCHITECT WHEN PREP WORK IS COMPLETE. ARCHITECT SHALL INSPECT AND SIGN OFF ON PREP WORK PRIOR TO ANY PAINTING
12.	PAINT RELOCATABLE HANDRAILS AND POSTS (TYPICAL). SAND HANDRAILS TO SMOOTH FINISH - SEE GENERAL NOTE #11 - NO WORK AT GALVANIZED HANDRAILS
13.	TEMPORARY TOILET FACILITIES SHALL BE PROVIDED PER THE PROJECT MANUAL UNDER TEMPORARY FACILITIES
14.	NO PAINT ON FRP DOORS
15.	REMOVE PEELING PAINT WITH WIRE WHEEL - SEE GENERAL NOTE #11
16.	PAINT UNDERSIDE, GUTTERS, COLUMNS AND DOWNSPOUTS AT CANOPIES AND COVERED AREAS

	DENOTES BUILDING / SITE STRUCTURE. NO WORK (UNLESS NOTED OTHERWISE)
	DENOTES BUILDING / STRUCTURE TO BE PAINTED, INCLUDING CANOPIES, WALKWAYS OR OVERHANGS

CLIENT	ARCHITECT
RIVERBANK UNIFIED SCHOOL DISTRICT RUDY SERRATO, DIRECTOR OF M.O.T. 6715 7th STREET RIVERBANK, CALIFORNIA 95367 PH: (209) 869 3538 FAX: (209) 869 1487	TIMOTHY P. HUFF & ASSOCIATES, INC. DBA: TPH ARCHITECTS JONATHAN E. GISH, AIA, PRINCIPAL ARCHITECT 519 McHENRY AVENUE MODESTO, CALIFORNIA 95354 PH: (209) 571 2232 FAX: (209) 571 1936

SHEET NOTES	
SN.01	PAINT WALL MOUNTED MECHANICAL UNITS - TYPICAL
SN.02	REMOVE EXPANDED MESH/METAL SCREENS FROM WINDOWS - PAINT AND RE-INSTALL
SN.03	PAINT WOOD BENCHES - FIELD VERIFY QUANTITY
SN.04	DO NOT PAINT PREFINISHED METAL WALL AND SOFFIT PANELS (RED COLOR) THIS BUILDING
SN.05	APPLY ANTI-SKID PRODUCT AT ALL RELOCATABLE BUILDING STEEL RAMPS - TYPICAL - NO WORK AT CONCRETE RAMPS UNO
SN.06	DO NOT PAINT EXISTING MURAL
SN.10	PAINT ELECTRICAL EQUIPMENT ENCLOSURES
SN.11	EXISTING ASPHALT SHINGLES AT SCREEN WALL TO BE REMOVED AND REPLACED WITH METAL PANELS BY OTHERS - PROVIDE PAINT FINISH
SN.12	PAINT ROOFTOP MECHANICAL SCREEN WALLS - TYPICAL
SN.13	PAINT SOFFIT LIDS ONLY THIS BUILDING

GENERAL NOTES

LEGEND

PROJECT TEAM

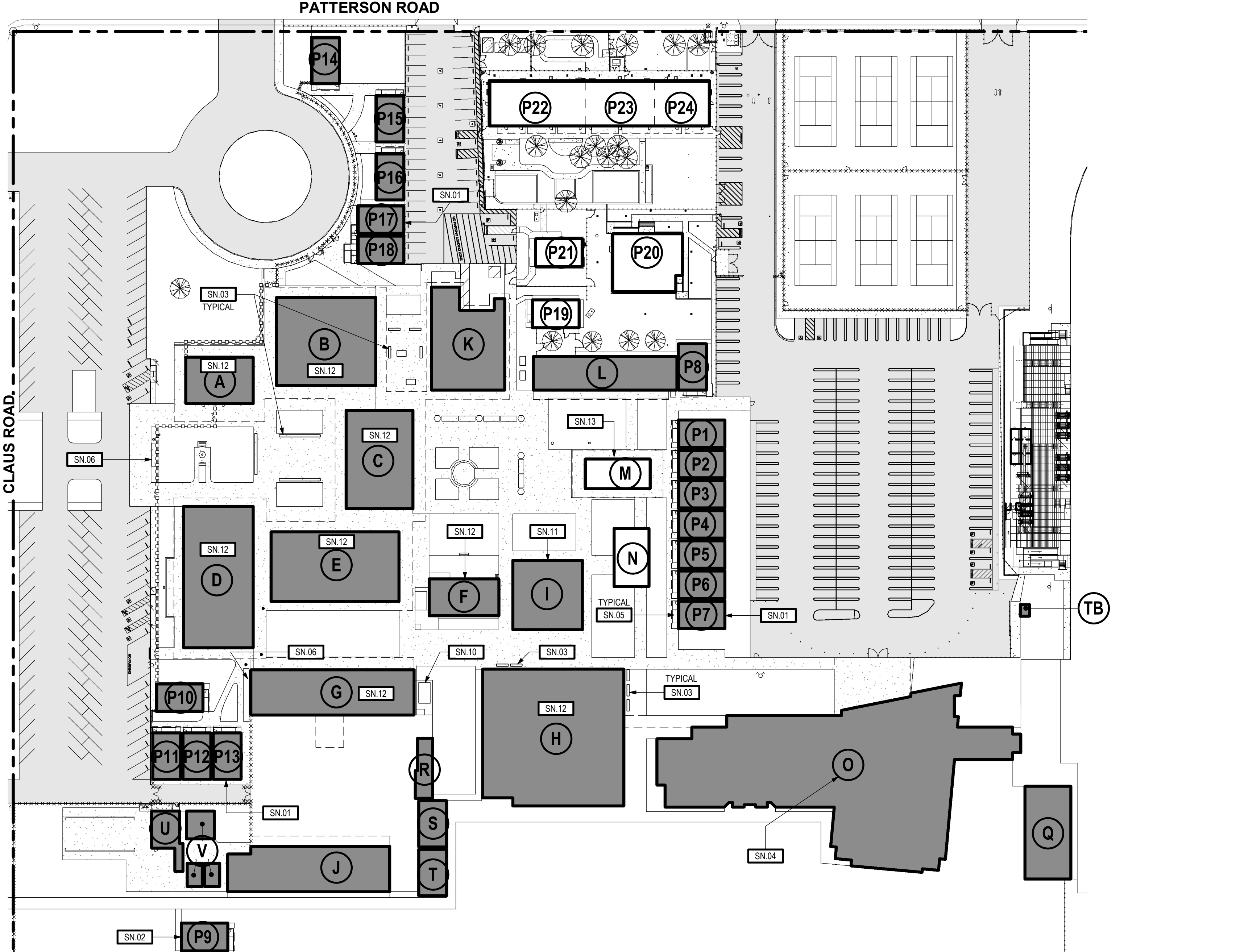

SHEET NOTES

CS COVER SHEET

SHEET INDEX

SCOPE OF WORK SHALL INCLUDE BUT NOT BE LIMITED TO PREPARATION AND PAINTING OF ALL PREVIOUSLY PAINTED SURFACES AT BUILDINGS AND STRUCTURES INDICATED. SEE GENERAL NOTES, SHEET NOTES AND SPECIFICATIONS FOR ADDITIONAL INFORMATION

MATERIAL ALLOWANCES:

THE CONTRACTOR SHALL IN THEIR BASE BID INCLUDE ALLOWANCES FOR REMOVAL AND REPLACEMENT OF THE FOLLOWING MATERIALS IN THE QUANTITIES INDICATED:

T1-11 WOOD SIDING:	50 4'X8' SHEETS
1X4 WINDOW TRIM:	200 LINEAL FEET
2X2 CORNER TRIM:	200 LINEAL FEET
5/8" PLYWOOD SKIRTING:	320 SQUARE FEET

SCOPE OF WORK

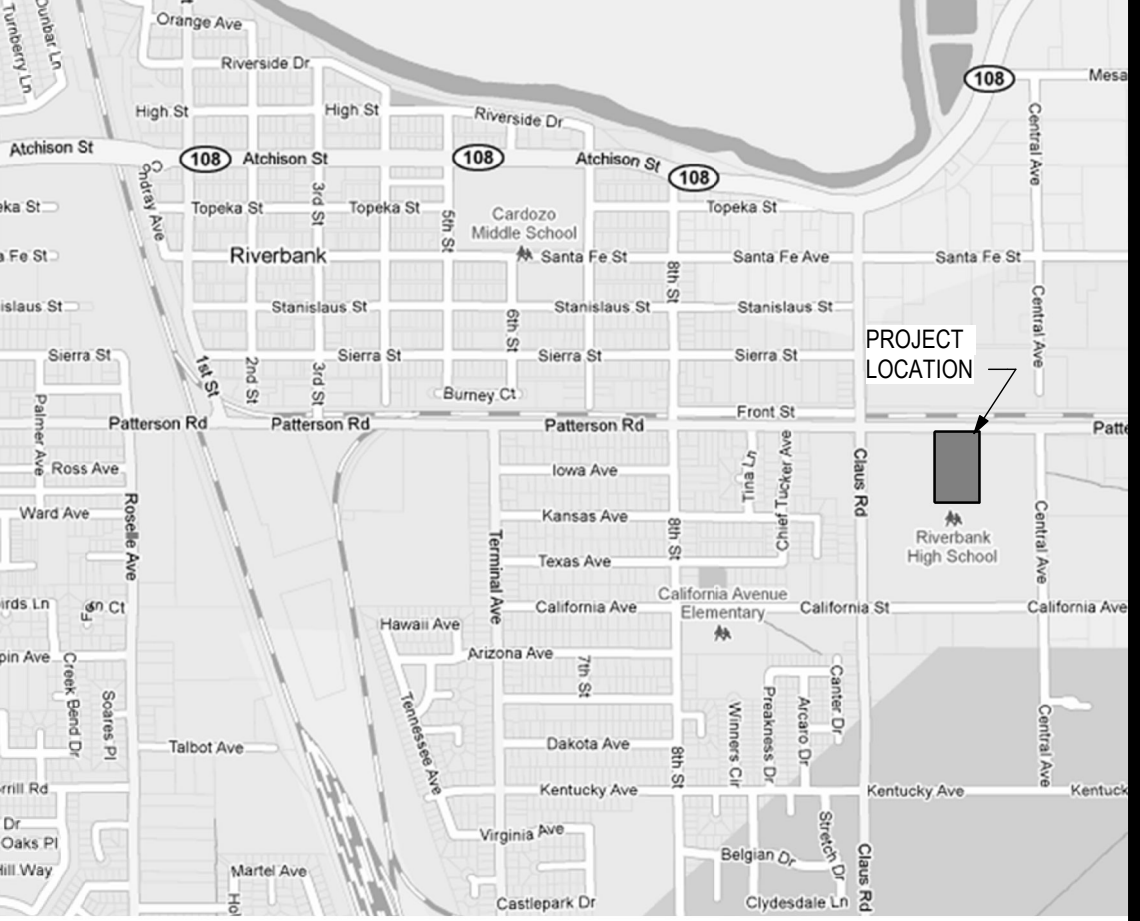

VICINITY MAP

EXTERIOR PAINTING AT RIVERBANK HIGH SCHOOL

RIVERBANK UNIFIED SCHOOL DISTRICT

COVER SHEET

No.	Description	Date

Project Number	2603
Date	APR 2026
Drawn by	R/RM
Checked by	JM

CS

Plot Date & Time 4/16/2026 8:49:28 AM

C:\Local\2603 Riverbank HS Painting_CENTRAL_jeffm.rvt